

Annex A

Site Locality Map and Site Plan

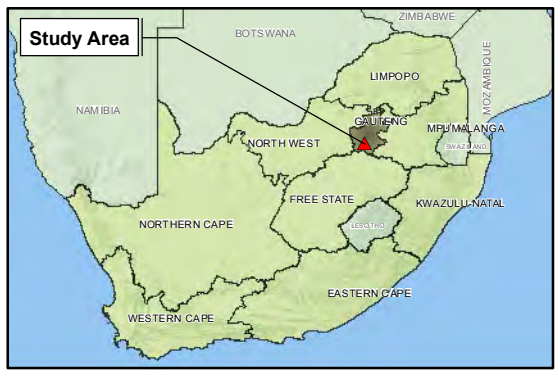

- ### Legend
- ▲ Facility Location
 - Arterial Route
 - Secondary Road
 - Other Roads
 - Track and Hiking Trail
 - Railway line
 - Perennial River
 - Non - Perennial River
 - Site Boundary
 - Wetlands
 - Water Bodies
 - Residential Areas
 - Portions and Holdings



TITLE:

Locality Map of the Proposed Acetylene Gas Production Facility

CLIENT:

DATE: Nov 2013	CHECKED: KM	PROJECT: 0220780
DRAWN: AT	APPROVED: SP	SCALE: 1 : 15 000
DRAWING: Ortho Locality Map of Air Products SA.mxd		REV: 0

ERM
 Building 32,
 The Woodlands,
 Woodlands Drive,
 Woodmead, 2148
 Johannesburg, South Africa
 Tel: +27 11 798 4300
 Fax: +27 11 804 2289

Projection: Transverse Mercator, CM 27, Datum: WGS 84 Source: NGI - Vector, Source: Bing Maps; Aerial - Bing Maps ©2010 Microsoft Corporation and its data suppliers. Reproduced under license with ARGIS 10 - July 2012. Geosites: NGA. Inset: ESRI Data

- A = Cylinder Maintenance
- B = Work Shop
- C = Cylinder Storage Area
- D = Lime Corral
- E = Full Carbide storage - indoor
- F = Empty Carbide storage - outside
- G = Generator Room
- H = Compressor Room
- I = Fill Hall
- J = Storage Area
- K = MCC & Electrical Panel Room
- L = Corridors
- M = Vent Manifolds
- N = Acetone Tank
- O = Nitrogen
- P = Fire Water
- Q = Sludge Tanks
- FUTURE - GREEN
- BLAST WALLS - BOLD LINES

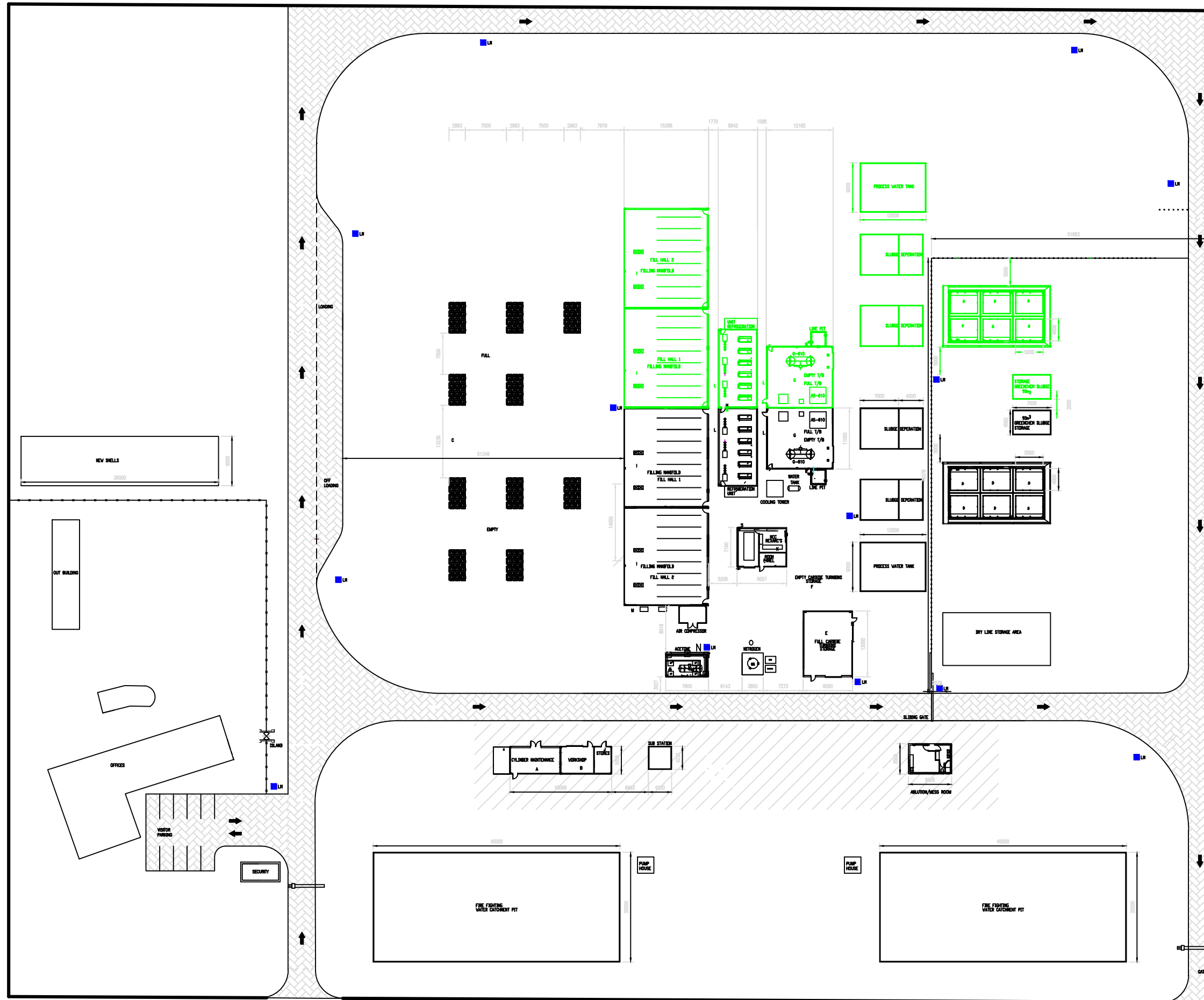

THIS DRAWING IS THE PROPERTY OF AIR PRODUCTS SOUTH AFRICA (PTY.) LTD. IT MUST NOT BE REPRODUCED OR USED FOR PURPOSES OTHER THAN FOR WHICH IT WAS SUPPLIED.					
ACETYLENE PLANT LAYOUT FUTURE - MIDVAAL					
AIR PRODUCTS SOUTH AFRICA (PTY.) LIMITED					
REV. No.	DESCRIPTION	DATE	DRAWN	CHK'D	APP'D
0	ORIGINAL	8/10/2013	GROUWER		
SCALE: AS SHOWN		FILE No. MW-101001		DRG. No. MW-101001	
PLT SCALE: 1:525		SHEET No. A2		SHEET 1 OF 1	